

### HORQUILLA FIJA HF 160

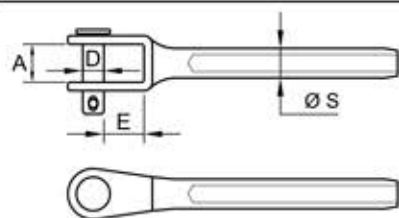

|           |      |
|-----------|------|
| <b>A</b>  | 30   |
| <b>D</b>  | 25,4 |
| <b>E</b>  | 49   |
| <b>ØS</b> | 28   |

### TENSOR HORQUILLA FIJA RHF 160

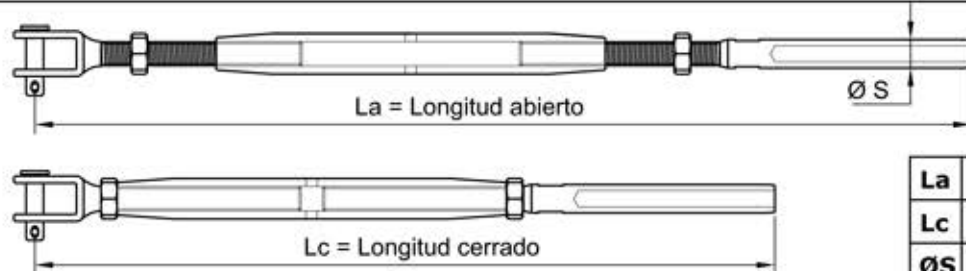

|           |     |
|-----------|-----|
| <b>La</b> | 863 |
| <b>Lc</b> | 633 |
| <b>ØS</b> | 28  |

### CABLE INOXIDABLE 316



1 x 19



|                          |          |
|--------------------------|----------|
| <b>Cable Ø</b>           | 16       |
| <b>Carga rotura (kg)</b> | 18.140   |
| <b>Composición</b>       | 1x19     |
| <b>Calidad</b>           | AISI 316 |
| <b>Límite elástico</b>   | 70 %     |

### DIMENSIONADO DEL PUNTO DE ANCLAJE

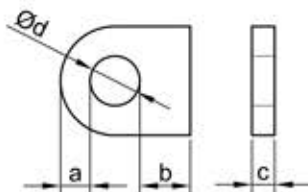

|          | Min | Max |
|----------|-----|-----|
| <b>a</b> | 27  | 40  |
| <b>b</b> | 25  | X   |
| <b>c</b> | 20  | 26  |
| <b>d</b> | 28  | X   |

IGENA, S.A.

Tel : 93 753 17 11  
Fax : 93 753 31 59

HORQUILLA FIJA  
TENSOR DE HORQUILLA FIJA

HF 160 - RHF 160



Cotas en mm

Plano B08